

Flour Milling

BINSWEEP® Rotary Dischargers BSN



2



Description ▼

The BINSWEEP® Rotary Discharger is a device through which powders or granular materials are discharged from small size bins or hoppers provided there is a low headload. Flanged on the outlet of the bin or hopper, BINSWEEP® has a bottom disc equipped with two rotating arms fixed at its centre. Scrapers are fitted on the lower end of the arms that move the material towards an outlet spout in the bottom plate. A gear motor that applies motion to the rotary arms is mounted outside in the bottom centre of the disc.

Function ▼

The BINSWEEP® Rotary Discharger is an efficient discharging device for a variety of powders and granular materials. It is applicable to small bins or hoppers. Its low height reduces the overall dimensions of the system layout.

BINSWEEP® is frequently used for the recovery of dust from medium-size dust collectors and as a discharging device fitted beneath manual bag openers.



Application ▼

The BINSWEEP® Rotary Discharger enables efficient discharging and cleaning of the material collecting hopper fitted beneath the manual bag opener. Thanks to BINSWEEP® the bags can be opened at a comfortable work height. In this way a special steep-angle underground hopper design can be avoided.

Benefits ▼

- ✓ **Continuous, even discharging;**
- ✓ **Minimum space required;**
- ✓ **Low maintenance costs due to equipment components highly resistant to wear;**
- ✓ **Minimum material residue.**

Flour Milling

BINSWEEP® Rotary Dischargers BSN



Technical Features / Performance ▼

- ▶ Body material: mild steel or stainless steel;
- ▶ Low operating noise level

Overall Dimensions ▼

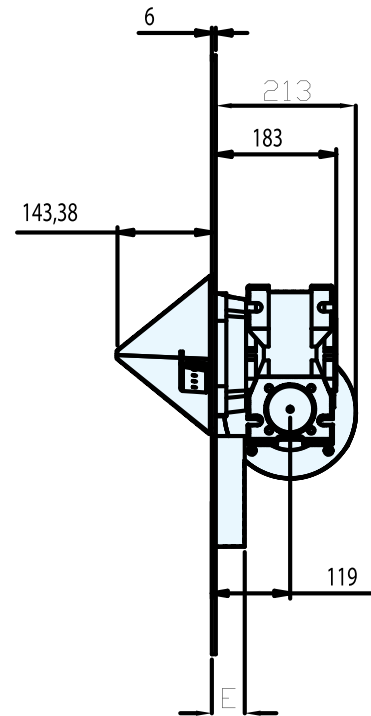
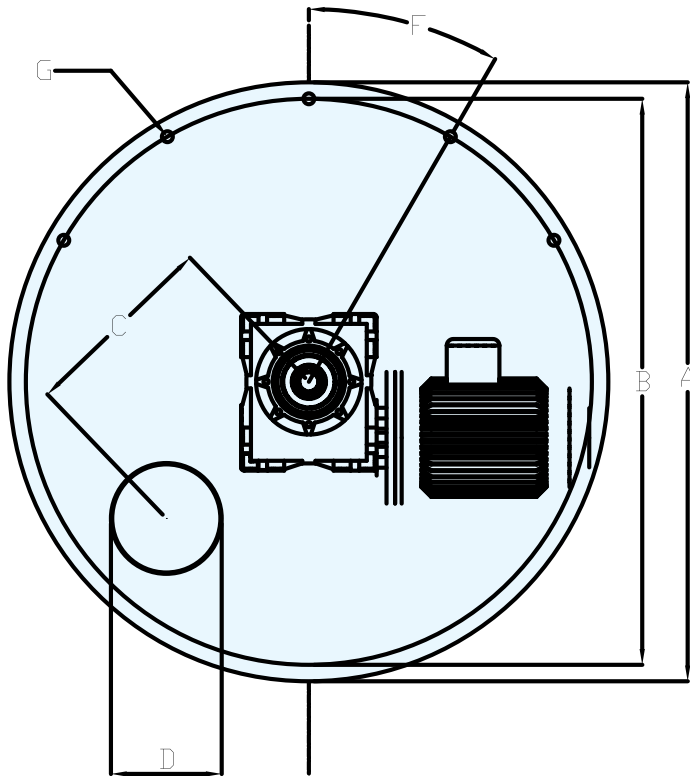

	BSN 075	BSN 090
A (mm)	910	1,075
B (mm)	860	1,020
C (mm)	300	359
D (mm)	168	193
E (mm)	50	50
Nbr. of G	12	12
Ø G (mm)	16.5	16.5
F	30°	30°
kW	1.1 - 1.5	1.1 - 1.5
RPM	14	14

Further outlet dimensions reported in Technical Catalogue

This datasheet might not show the complete range but only the models most suitable for the application.